

# Stunning I-95 Visibility: **MAJOR REDUCED PRICE** Ideal Mix-Use, Industrial or Critical Facility Site

I-95 - Exit 110 | Caroline County, Virginia



## PROPERTY HIGHLIGHTS

- **Zoned B-1** <click for more info>
- 1,500± feet of I-95 frontage
- 67,000 SF Building
- 97 Acres
- 65 Miles south of DC and 25 miles north of Richmond
- 2 Exits north of Kings Dominion
- **DEVELOPMENT 1 MILLION SQ FT**  
(example on page 2)
- High interstate visibility
- Cleared land
- **Utilities on Site**
- **MAJOR REDUCED PRICE**



John Jay Schwartz, MCR, RPA  
phone (804) 740-1555  
jjschwartz@havesitewilltravel.com  
www.HaveSiteWillTravel.com





# Stunning I-95 Visibility: MAJOR REDUCED PRICE

## Ideal Mix-Use, Industrial or Critical Facility Site

I-95 - Exit 110 | Caroline County, Virginia



Sketch Index			
Map No. 53 A 64B			
Building 2			
Sect	Type	Stories	SqFt
A	Retail-metal	1.00	75520
B	Porch	1.00	60
C	Porch	1.00	200
D	Porch	1.00	200
F	Porch	1.00	200
G	Porch	1.00	200
H	Porch	1.00	60
I	Porch	1.00	240

This Sketch only represents the Exterior of the Structure and does not contain any Internal structural details.

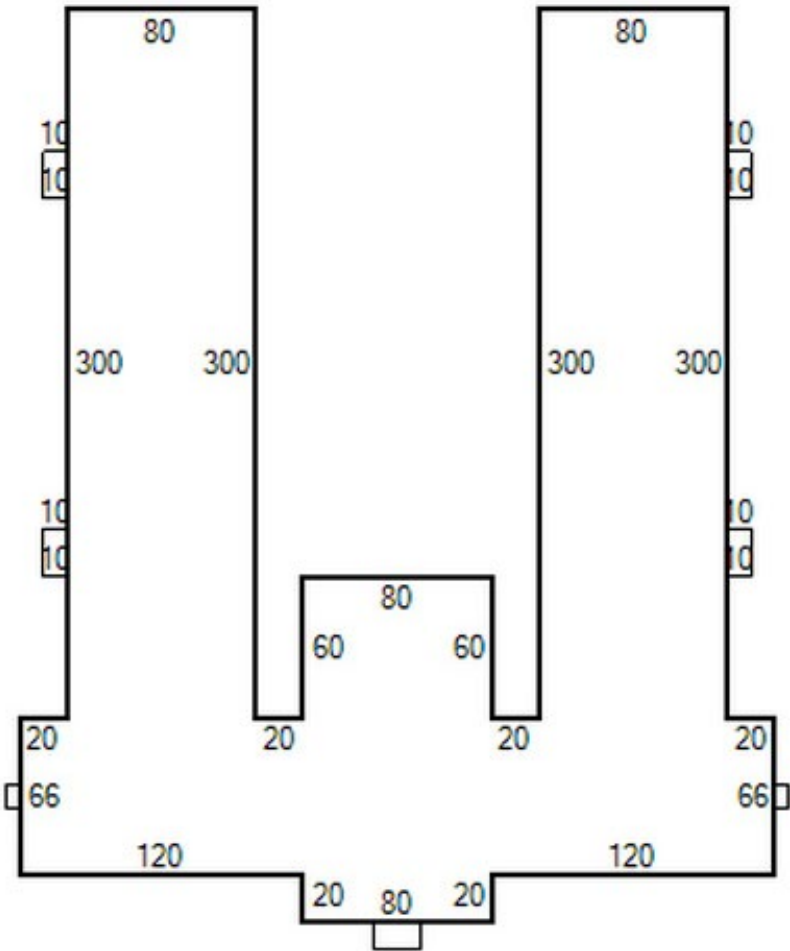

John Jay Schwartz, MCR, RPA  
phone (804) 740-1555  
jjschwartz@havesitewilltravel.com  
www.HaveSiteWillTravel.com



# Stunning I-95 Visibility: **MAJOR REDUCED PRICE** Ideal Mix-Use, Industrial or Critical Facility Site

I-95 - Exit 110 | Caroline County, Virginia

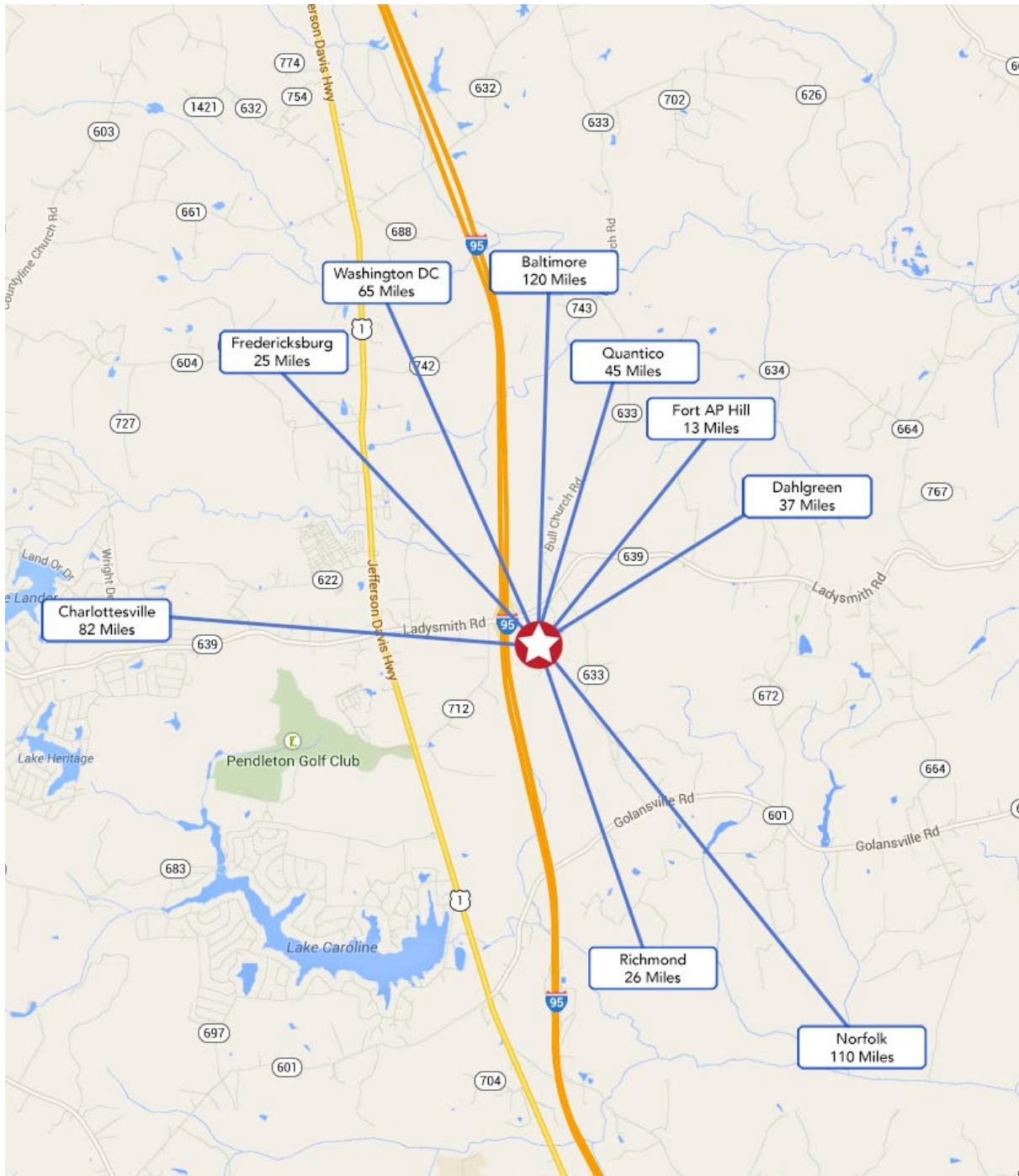

John Jay Schwartz, MCR, RPA  
phone (804) 740-1555  
jjschwartz@havesitewilltravel.com  
www.HaveSiteWillTravel.com